



High Purity Indicating Switch, Types HSXG and HSGG

The new Ashcroft® HSXG and HSGG 2 inch switch gauges combine clean, reliable pressure indication and setpoint monitoring in a small, easy-to-set instrument.

The Ashcroft® HSXG and HSGG are high purity indicating pressure switches designed to monitor gases used in the semiconductor industry. The one-piece polycarbonate switch frame ensures ease of setpoint adjustment and long life. The hermetically sealed reed switch opens or closes a low-voltage circuit to control relays, alarms or input to microprocessors. The “on-dial” setpoint can be adjusted anywhere between 5% and 92% of range.

Indicating Switch Features

Low dead volume Bourdon tube designs

Center back or lower connection mounting

Convenient “on-dial” setpoint adjustment

Electropolished 10Ra corrosion-resistant surface finishes

SWITCH GAUGE PERFORMANCE – Single setpoint – set at factory for ascending or descending operation

Indication Accuracy:	1% F.S.	Maximum Switching Voltage: 30V ac/dc
Switch Point Repeatability:	0.25% F.S.	Maximum Switching Current: 0.2 amps ac/dc
Switch Point Deadband:	±3% F.S.	Switch Power Rating: 4W dc
Switch Lead:	1 pair, 28 gauge, trimmed and tinned as standard, 4 ft.	

NEW!

ISO 9001
REGISTERED FIRM

INSTRUMENT

High Purity Indicating Switch Type HSXG and HSGG



PRODUCT SPECIFICATIONS

Size: 2" (50mm)
Window: One piece. Snap-on polycarbonate
Pointer: Black aluminum, adjustable
Dial: Aluminum, high-resolution white with black grads
Available Scales: psi, bar, kPa (single or dual scale)
Proof Pressure: 15#-1000# 130% F.S. > 1000# 110% F.S.
Burst Pressure: 15#-600# 10 x F.S. > 1000# 2 x F.S.
Mounting: Center back, lower, front flange

	HSXG	HSGG
Case:	304 SS electropolished	304 SS polished
Accuracy:	1% F.S.	1% F.S. ≤ 1500 psi 2% F.S. ≥ 2000 psi
Socket/gland:	316L SS VAR Electropolished < 10 Ra	316L SS
Bourdon Tube:	Seamless 316L SS Passivated	Seamless 316L SS
Helium Leak Tested	1 X 10 ⁻⁹ SCC/SEC (inboard)	
Pressure Connections:	Male or female swivel face seal	¼ NPT

How to Order:

2 0 - H S - G G - 4 - F - L - E - A O - V & 3 0 0 # - F F

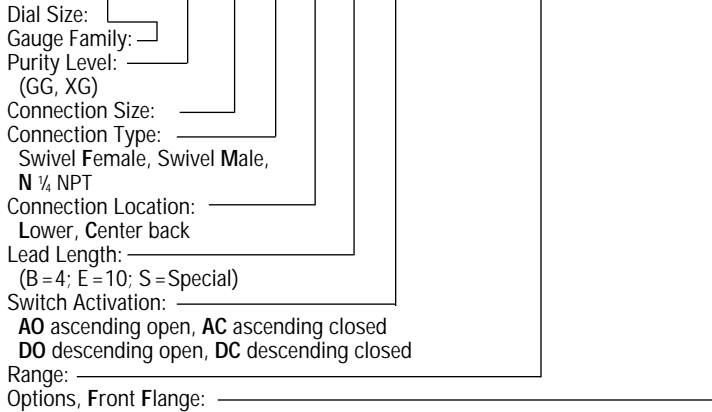

Range (V) InHg	Range (#) psig	Number Interval		Minor Graduation Subdivision	
		InHg	psig	InHg	psig
30"		3		.5	
30"	& 0-15	5	3	1	.5
30"	& 0-30	10	5	1	.5
30"	& 0-60	10	10	2	1
30"	& 0-100	10	10	2	1
30"	& 0-160	30	20	5	2
30"	& 0-200	30	20	5	2
30"	& 0-300	30	30	5	5
	0-15		1		.2
	0-30		3		.5
	0-60		5		1
	0-100		10		1
	0-160		20		2
	0-200		20		2
	0-300		30		5
	0-600		100		10
	0-1000		100		10
	0-1500		300		20
	0-2000		200		20
	0-3000		300		50
	0-4000		500		50

ASHCROFT® and True Zero™ are trademarks of Dresser Instrument Division, Dresser Equipment Group, Inc.
 *VCR is trademark of Cajon Co.

¼ NPT Male – Back

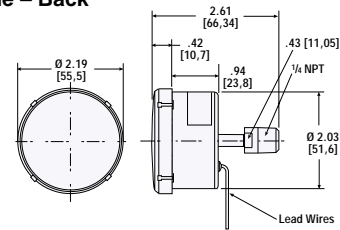

¼ NPT Male – Lower

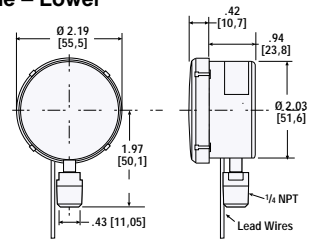

¼ Swivel Male VCR* – Back

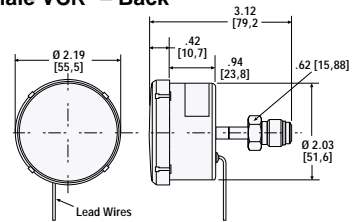

¼ Swivel Male VCR – Lower

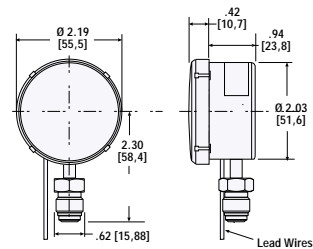

¼ Swivel Female VCR – Back

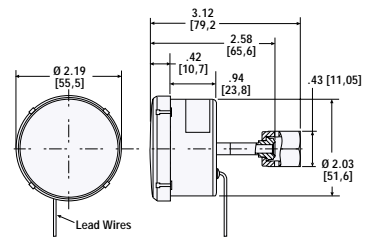

¼ Swivel Female VCR – Lower

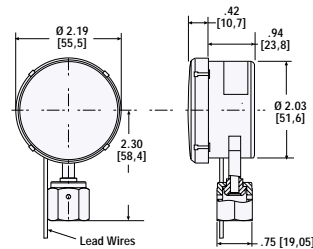

© Dresser Instrument, Dresser Equipment Group, Inc. 9/99
 Specifications subject to change without notice. Subject to standard terms and conditions of sale. 2.5M SP 1P-9/99